

F-557

Peter Merckle

M-359

PAGE-259

Richd Mason

C-141-228

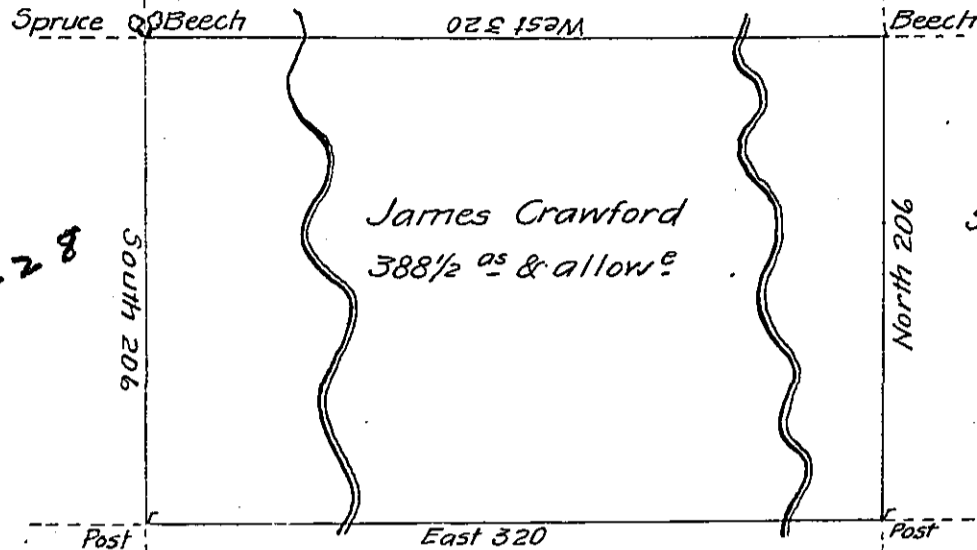

Solomon Morachie

D-30-296

C-141-236

Adam Striker

A-28-295

C-141-206

A draught of a tract of land called _____ situate on the waters
of Wyolusing Creek joining land surv'd for Peter Merckle and others in Luzern
(formerly North d.) County containing three hundred and eighty eight acres 1/2
& allowe of six P Cent for roads &c. Surv'd for James Crawford the 31st day
of August 1787 in pursuance of a warrant dated the 27th day of July 1787

by

To John Lukens Esqr.

Surv^r Genl

W^m Gray D.S.

IN TESTIMONY that the above is a copy of the original remaining on file in
the Department of Internal Affairs of Pennsylvania, made
conformably to an Act of Assembly approved the 16th day of
February, 1833, I have hereunto set my Hand and caused
the Seal of said Department to be affixed at Harrisburg,
this twenty eighth day of June 1904

Joseph P. Brown
Secretary of Internal Affairs.